



# LHT Series-High Temperature

## LHT2-1000(2V1000Ah)



### Specifications

Rated Voltage	2V	
Nominal Capacity	1000Ah	(C <sub>10</sub> , 1.80V/cell)
Dimension	Length	475±3mm (18.7 inches)
	Width	175±2mm (6.89 inches)
	Container Height	328±3mm (12.9 inches)
	Total Height	350±3mm (13.8 inches)
Approx Weight	60.0kg (132.3 lbs)	
Terminal	M8	
Container Material	PC-ABS flame retardant jar and cover to UL94 V-0	
Rated Capacity (35°C)	1060.0 Ah	(20hr, 53.0A, 1.80V/cell)
	1000.0 Ah	(10hr, 100.0A, 1.80V/cell)
	888.0 Ah	(5hr, 177.6A, 1.75V/cell)
	795.0 Ah	(3hr, 265.0A, 1.75V/cell)
	641.1 Ah	(1hr, 641.1A, 1.60V/cell)
Max. Discharge Current	8000A	
Internal Resistance (35°C)	Approx 0.3mΩ	
Operating Temp. Range	Discharge	-40 ~ 65°C (-40 ~ 149°F)
	Charge	-20 ~ 45°C (-4 ~ 113°F)
	Storage	-20 ~ 50°C (-4 ~ 122°F)
Nominal Operating Temp. Range	25±10°C (77±18°F)	
Cycle Use	Initial Charging Current less than 250A. Voltage 2.30V~2.40V at 35°C(95°F)Temp. Coefficient -5mV/°C	
	Initial Charging Current less than 250A. Voltage 2.20V~2.27V at 35°C(95°F)Temp. Coefficient -3mV/°C	
Effect of temp. to Capacity	40°C (104°F)	103%
	35°C (95°F)	100%
	0°C (32°F)	79%
Self Discharge	LHT series batteries may be stored for up to 9 months at 35°C(95°F) and then a freshening charge is required. For higher temperatures the time interval will be shorter.	

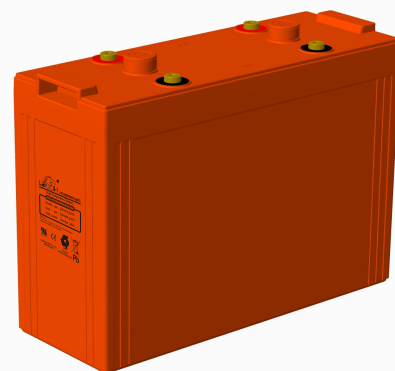

### Layout

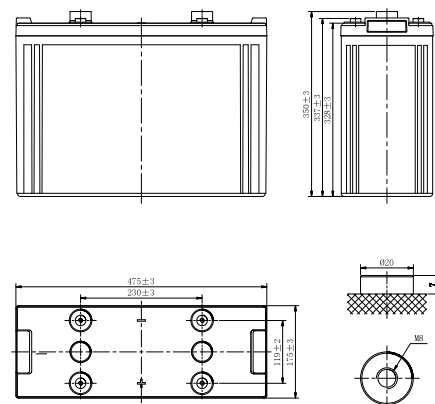

### Constant Current Discharge (Amperes) at 35 °C (95°F)

F.V/Time	5min	10min	15min	20min	30min	45min	1h	2h	3h	4h	5h	6h	8h	10h	20h
1.85V/cell	1166.7	990.0	903.6	813.0	684.0	560.0	471.0	312.0	240.6	194.3	163.8	142.8	114.0	95.6	50.6
1.80V/cell	1420.0	1158.0	1029.7	915.0	754.0	608.0	510.6	333.0	252.6	202.5	170.6	148.0	118.8	100.0	53.0
1.75V/cell	1659.7	1332.0	1165.0	1026.0	826.0	662.7	557.6	352.0	265.0	212.5	177.6	153.5	122.0	102.0	54.1
1.70V/cell	1899.3	1494.0	1287.6	1116.0	888.0	702.7	589.9	369.5	276.7	220.0	182.9	158.3	125.6	104.5	55.4
1.67V/cell	2039.1	1608.0	1388.0	1200.0	940.0	733.3	615.0	384.0	285.5	226.3	187.9	162.0	127.3	106.2	56.3
1.60V/cell	2220.0	1722.0	1472.0	1260.0	982.0	765.3	641.1	398.5	292.2	231.3	191.8	165.0	129.5	107.2	56.7

### Constant Power Discharge(Watts/cell) at 35 °C (95°F)

F.V/Time	5min	10min	15min	20min	30min	45min	1h	2h	3h	4h	5h	6h	8h	10h	20h
1.85V/cell	2179.0	1862.5	1710.9	1546.3	1307.2	1076.7	911.1	606.9	470.2	381.0	322.7	282.2	226.2	190.1	100.8
1.80V/cell	2608.6	2146.9	1924.5	1722.0	1429.4	1161.3	982.1	644.6	491.4	395.8	334.6	291.3	234.9	198.6	105.4
1.75V/cell	2995.7	2430.2	2146.6	1908.9	1554.0	1258.3	1067.8	678.7	514.1	414.0	347.1	301.2	240.8	202.3	107.3
1.70V/cell	3371.3	2687.7	2348.3	2058.6	1656.6	1324.9	1123.8	709.4	534.7	426.8	356.4	310.2	247.7	207.1	109.9
1.67V/cell	3554.2	2849.7	2499.8	2189.8	1740.5	1375.0	1164.9	734.2	549.3	437.5	364.9	316.4	250.3	210.2	111.6
1.60V/cell	3789.5	2992.0	2607.2	2273.0	1800.0	1421.6	1205.9	757.2	559.3	445.2	371.1	321.3	254.2	211.8	112.2



# LHT Series-High Temperature

## LHT2-1000(2V1000Ah)



### Applications

- Tele-communication base station
- High temperature station without air-condition
- Station in the open air
- Electric power system, UPS
- Solar energy, wind saving energy power supply

### General Features

- Battery design life up to 15 years at 35°C
- Special anti-high-temperature paste formula
- Special anti-high-temperature container
- Special double sealing and anti-high-temperature sealing agent
- High performance separator and special electrolyte formula

### Standards

- Compliance with IEC 60896 Certified
- Classified as "Very Long Life" according to Eurobat
- UL, CE Certified
- Manufactured in Leoch® IATF 16949, ISO 9001, ISO 14001 and ISO 45001 certified production facilities

### Discharge Characteristics

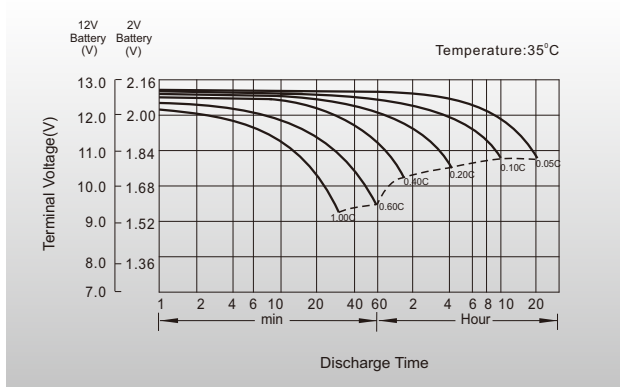

### Float Charging Characteristics

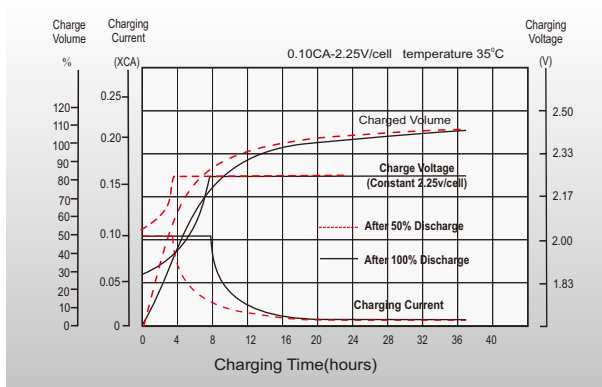

### Temperature Effects in Relation to Battery Capacity

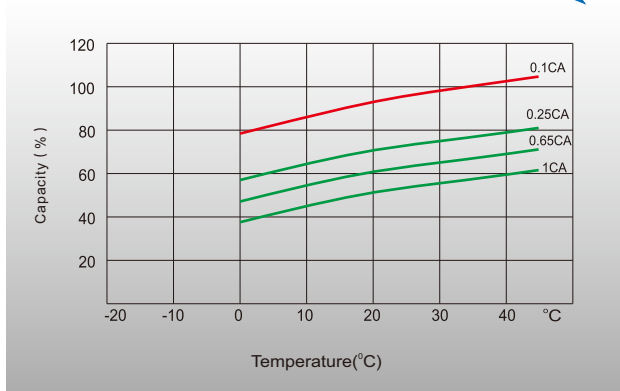

### Effect of Temperature on Long Term Float Life

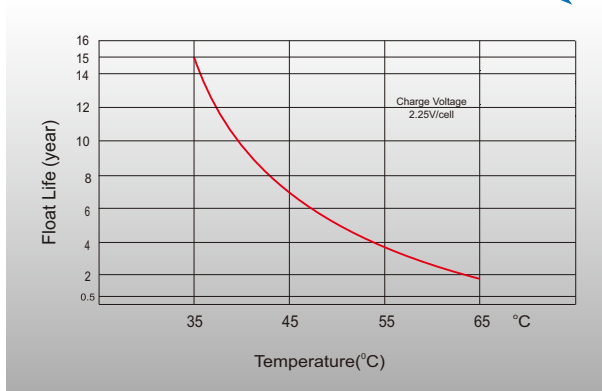

distributed by: Power Storage Deutschland GmbH

+49 (0)6081 96582-0

info@psd-power.de



www.psd-power.de



[Http://www.leoch.com](http://www.leoch.com)

© 2022 LEOCH. All rights reserved.  
 Trademarks and logos are the property of LEOCH and its affiliates unless otherwise noted.  
 Subject to revisions without prior notice.

Publication No.: LB-LHT2-1000-PD-EN-V2.2-202209