

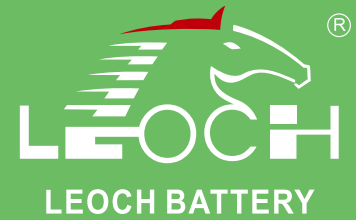

# LPC Series-Cycle Application

## LPC12-120(12V120Ah)



### Specifications

Rated Voltage	12V		
Rated Capacity(C <sub>10</sub> , 1.80V/cell)	120Ah		
Dimensions	Length	408±2mm (16.1 inches)	
	Width	177±2mm (6.97 inches)	
	Container Height	225±2mm (8.86 inches)	
	Total Height	225±2mm (8.86 inches)	
Approx Weight	37.3Kg (82.2 lbs)		
Terminal	M8		
Container Material	ABS		
Nominal Capacity(25°C)	126.0Ah	(20hr, 6.30A, 1.80V/cell)	
	105.5Ah	(5hr, 21.1A, 1.75V/cell)	
	97.8Ah	(3hr, 32.6A, 1.75V/cell)	
	80.8Ah	(2hr, 40.4A, 1.75V/cell)	
	76.0Ah	(1hr, 76.0A, 1.70V/cell)	
Short Circuit Current	2400A		
Internal Resistance(25°C)	≤3.6mΩ		
Operating Temp. Range	Discharge	-20 ~ 55°C (-4 ~ 131°F)	
	Charge	0 ~ 40°C (32 ~ 104°F)	
	Storage	-20 ~ 50°C (-4 ~ 122°F)	
Nominal Operating Temp. Range	25±3°C (77±5°F)		
Max.Charging Current(25°C)	30A		
Charge voltage(25°C)	Charge Voltage	Temp. Coefficient	
	Float	2.23~2.27V/cell	-3mV/cell/°C
Effect of temp. to Capacity	Cycle	2.40~2.45V/cell	-5mV/cell/°C
	40°C (104°F)		106%
	25°C (77°F)		100%
	0°C (32°F)		80%
Self Discharge	≤3%/month @ 25°C		



### Layout

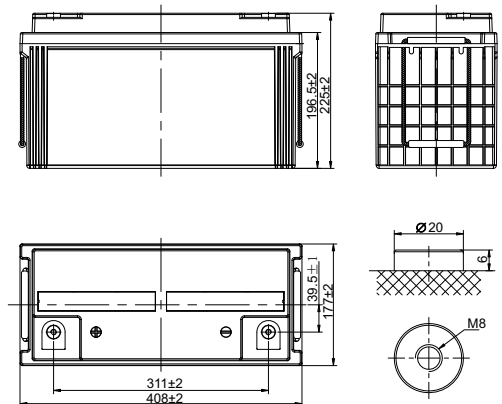

### Constant Current Discharge (Amperes) at 25 °C (77°F)

F.V/Time	1h	2h	3h	4h	5h	6h	8h	10h	20h
1.85V/cell	66.6	37.1	30.0	23.3	19.8	17.2	13.9	11.7	6.14
1.80V/cell	71.0	39.0	31.4	24.2	20.5	17.7	14.1	12.0	6.30
1.75V/cell	74.0	40.4	32.6	25.0	21.1	18.0	14.2	12.1	6.35
1.70V/cell	76.0	41.7	33.3	25.6	21.6	18.4	14.5	12.2	6.41

### Constant Power Discharge (Watts/cell) at 25 °C (77°F)

F.V/Time	1h	2h	3h	4h	5h	6h	8h	10h	20h
1.85V/cell	142.3	72.5	60.7	45.8	38.9	33.7	27.1	23.2	12.2
1.80V/cell	150.6	75.9	63.3	47.3	40.3	34.7	27.6	23.7	12.4
1.75V/cell	155.9	78.1	65.3	48.8	41.3	35.3	27.8	23.9	12.5
1.70V/cell	159.1	80.2	66.4	49.7	42.1	35.9	28.2	24.0	12.6



# LPC Series-Cycle Application

## LPC12-120(12V120Ah)

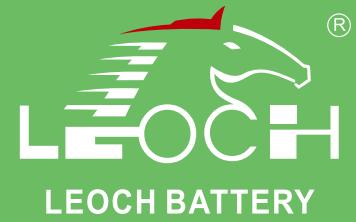

### Applications

- Electric tools
- Mobility Scooter
- Golf trolleys
- Portable lights and instruments
- Electric toys
- Portable power
- Electric wheelchair

### General Features

- Good cyclic property. Enhanced overcharge endurance and overdischarge recovery property
- Using oxygen recombination technology: maintenance-free
- Lower acid density, excess of electrolyte and larger distance between plates to keep battery at low temperature and slow down plate grid corrosion speed
- Unique plate group configuration, high quality AGM separator and battery management system ensure battery with a longer service life

### Standards

- ACC. to BCI standards
- Manufactured in Leoch® IATF 16949, ISO 9001, ISO 14001 and ISO 45001 certified production facilities

### Discharge Characteristics

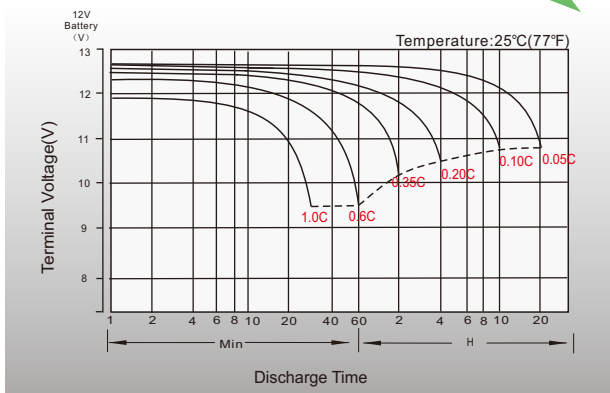

### Charging Characteristics

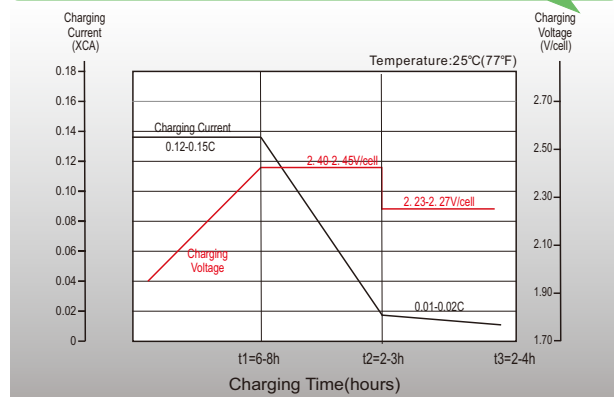

### Cycle Life in Relation to Depth of Discharge

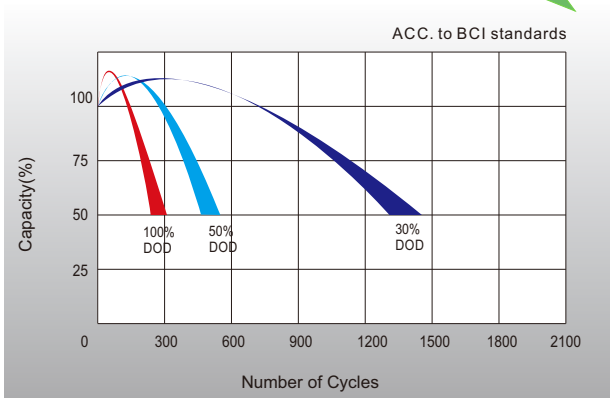

### Self Discharge Characteristics

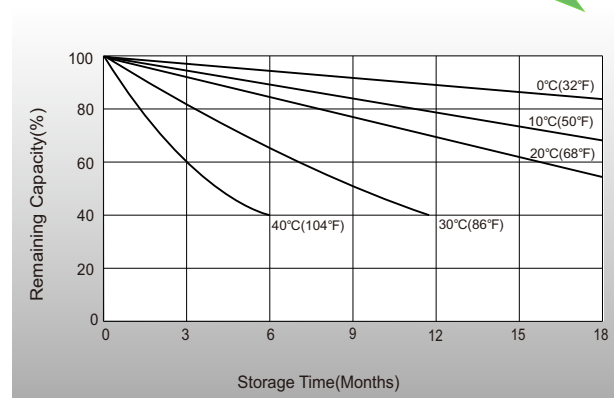

distributed by: Power Storage Deutschland GmbH

+49 (0)6081 96582-0

info@psd-power.de

www.psd-power.de



[Http://www.leoch.com](http://www.leoch.com)

© 2022 LEOCH. All rights reserved.  
 Trademarks and logos are the property of LEOCH and its affiliates unless otherwise noted.  
 Subject to revisions without prior notice.

Publication No.: LB-LPC12-120-PD-EN-V2.2-202212